

RS12 User Manual



Children should not use unsupervised



Do not exceed load capacity of **200KG**



Do not stand on the Chair



Take care when assembling



Small parts may be a choking hazard

What's in the box

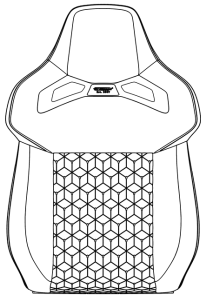

Seat Back

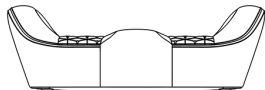

Seat Base

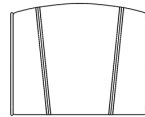

Lumbar Cushion

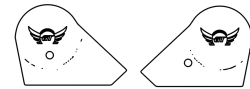

Cover Caps

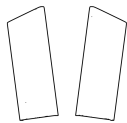

Side Caps



Long Bolts



Short Bolts



Allen Key

Care Guide



Clean up any spills immediately



Wipe clean with a damp cloth



For stubborn stains use warm, soapy water

ASSEMBLY INSTRUCTIONS

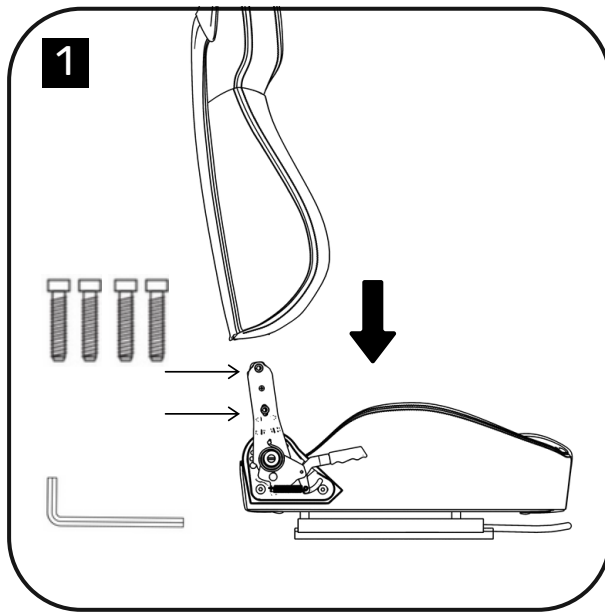

Position the seat back between the recliners and line up the mounting holes on both sides.

Screw into place using the four long bolts. Do not fully tighten until all four are in place.

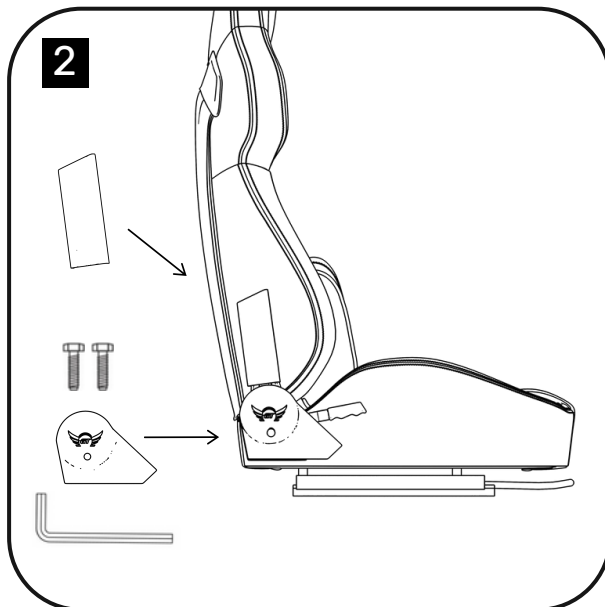

Attach the cover caps using the short bolts and then firmly push the side caps into place.



Ensure that you have received all parts according to the part checklist prior to installation. If any parts are missing or faulty, contact the **GT Omega support team** for replacements.



Avoid over-tightening screws. As this may damage the product.