



**CERTIFIED SIM RACING**



# PRIME LITE R

Assembly Guide

Recommended  
**1-2 People**



Read Instructions  
**10 Minutes**

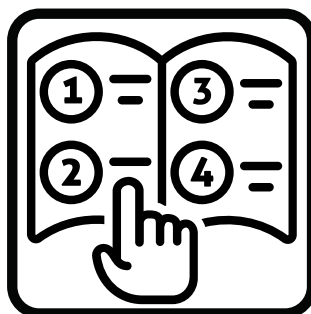

Assembly Time  
**60-120 Minutes**

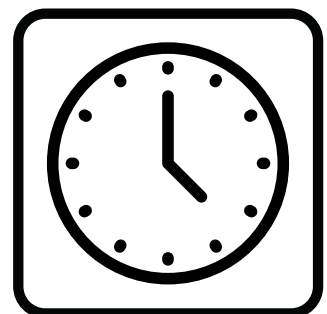

# TABLE OF CONTENT

PAGE 1

NOTICES

PAGE 2

WHAT'S IN THE BOX

PAGE 3 - 9

ASSEMBLY INSTRUCTIONS



**Need Help?** We're here for you! [Contact our support team:](#)



# WARNING



Children should not use unsupervised



Do not exceed load capacity of **200KG**



Do not stand on the Cockpit



Take care when assembling



Do not push or pull Cockpit



FAILURE TO COMPLY WITH OR OBSERVE ALL ASSEMBLY, SAFETY, AND OPERATION INSTRUCTIONS REGARDING THE USE OF THIS PRODUCT MAY RESULT IN **PROPERTY DAMAGE** OR **BODILY INJURY**.

- This document contains important safety regulations. Any non-conforming use may result in personal injury or mechanical damage.
- Please read this user manual carefully before use as it provides key information about safety, use, and assembly of the **PRIME LITE R Cockpit**.
- Ensure that you have received all parts according to the part checklist prior to installation. If any parts are missing or faulty, contact the GT Omega support team for replacements.
- **Do not** over tighten the screws during installation.
- This product contains small items that could be a choking hazard if swallowed. Keep these items away from children.
- This product is designed for indoor use only. Using the product outdoors could lead to product failure and personal injury.
- Alteration or modification of any factory components outlined in the checklist will automatically void your warranty.
- Place the **PRIME LITE R Cockpit** away from corrosive gas, water and dusty environments.

The **PRIME LITE R Cockpit** is designed for indoor use and dry work areas only. Under no circumstances does the manufacturer accept warranty claims or liability claims for damages caused from improper use or handling.

# WHAT'S IN THE BOX

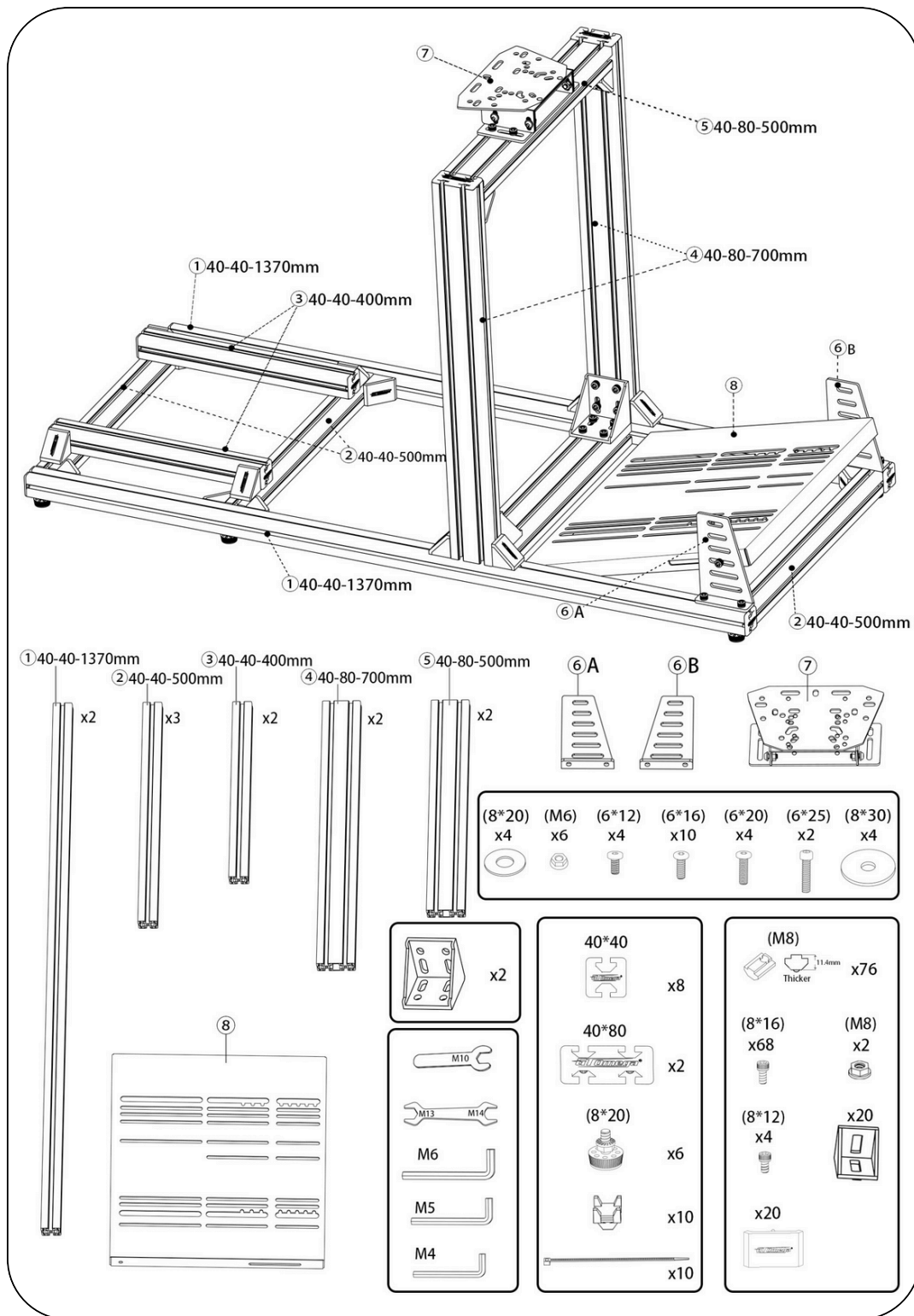

If you are missing any parts, please contact our customer support team who can assist.

# IMPORTANT

Please read the instructions carefully and **in full** before starting assembly. This will help prevent mistakes and the need to disassemble parts later.

1

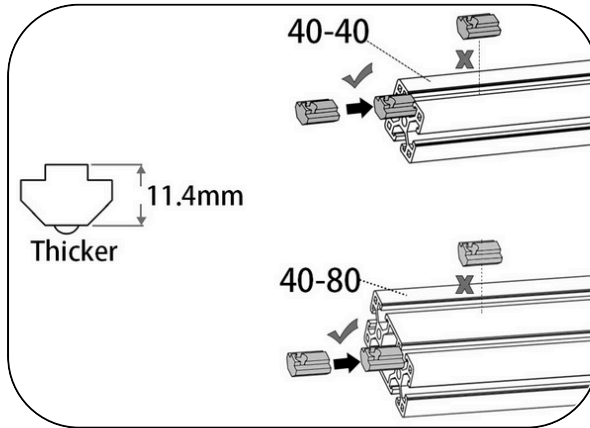

Insert the T-nuts from the end of the profile channels. Do not try to drop them in from above, they must slide in from the end.

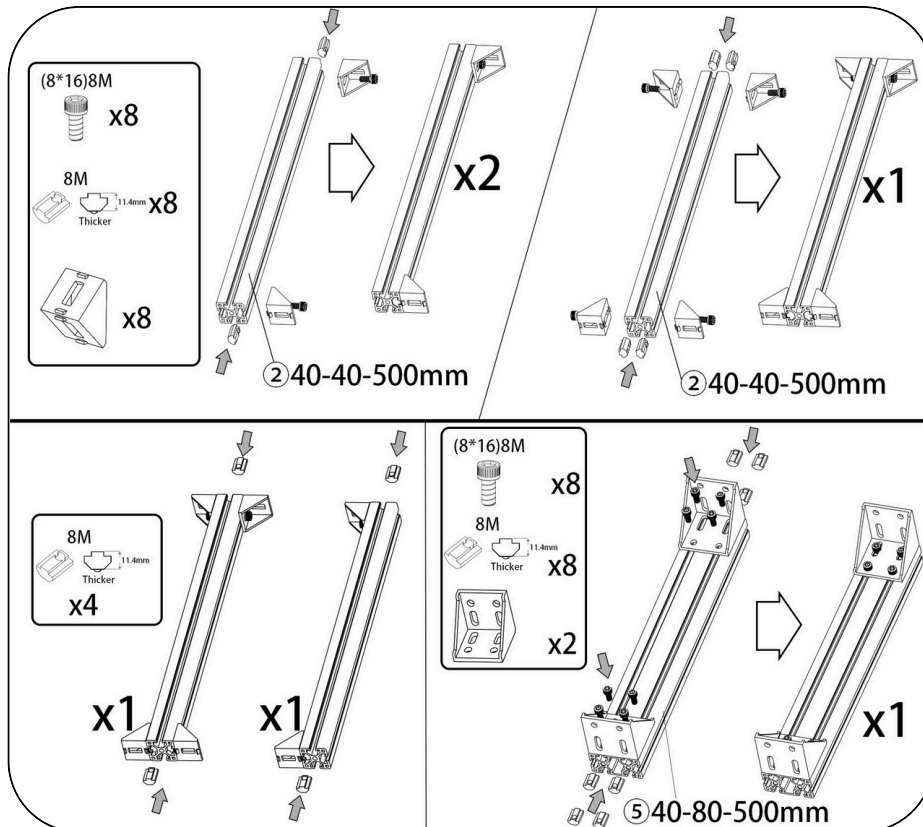

Attach corner brackets to the short profile sections (part 2) using bolts and T-nuts. Use the wider corner brackets for the wider section (part 5).

# ASSEMBLY INSTRUCTIONS

2

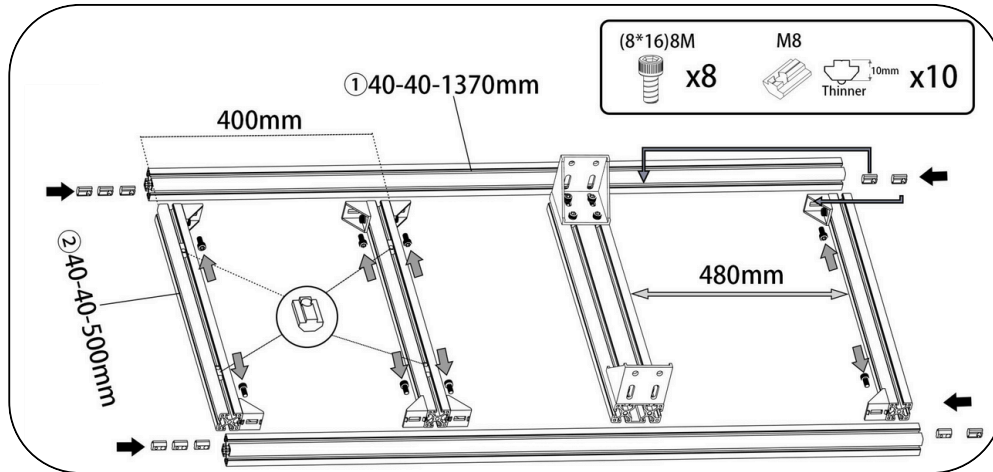

Bolt the opposite side of the corner brackets to the long profile sections (Part 1) as shown. Make sure to slide the T-nuts into the channels before tightening.



Make sure to add extra T-nuts in the top-facing channel before tightening. These will be needed for the seat brackets.

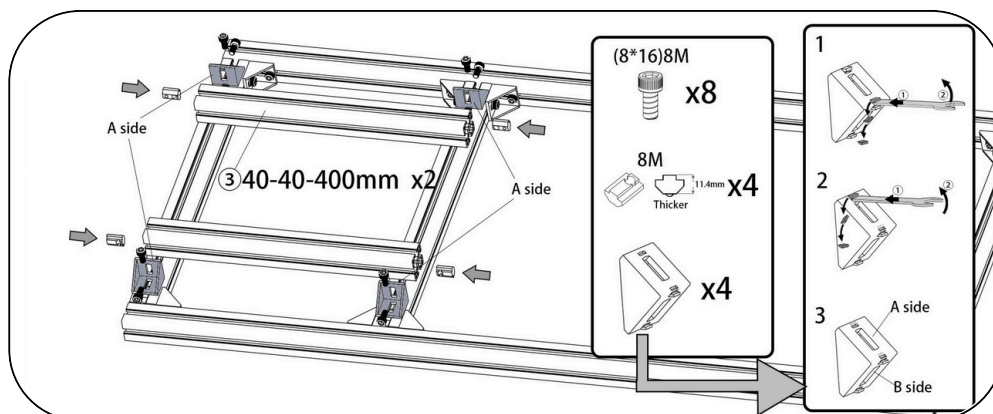

Attach the seat bracket sections (Part 3) to the top of the rear frame as shown. Leave the downward bolts slightly loose to adjust your seat position before fully securing.



Avoid over-tightening screws. As this may damage the product.

# ASSEMBLY INSTRUCTIONS

3

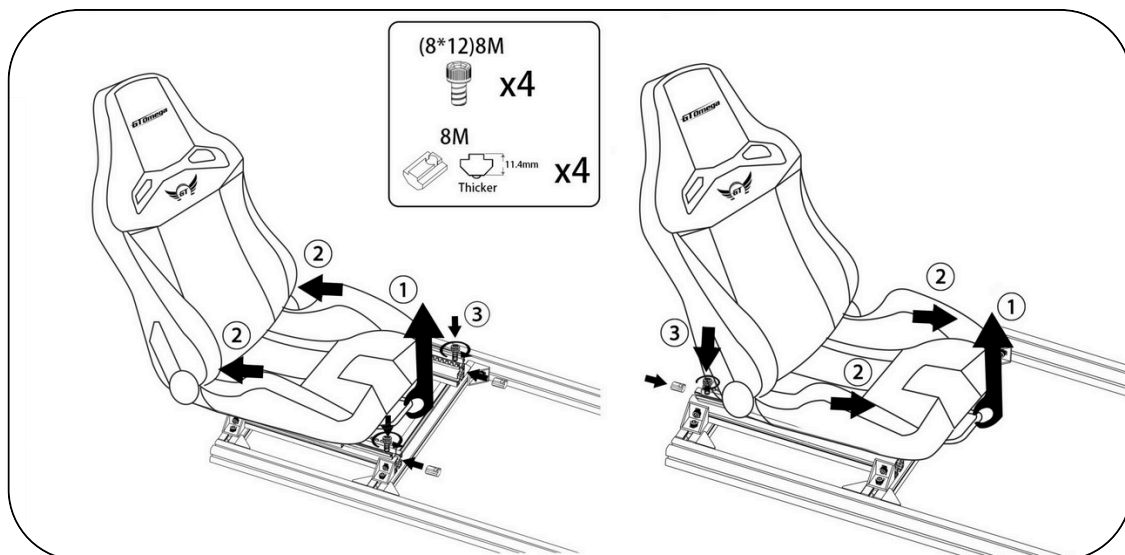

Slide the seat backward and secure the seat sliders to the seat brackets using T-nuts in the channels. Slide the seat forward, then repeat the process for the rear section of the sliders.



This installation guide is for GT Omega racing seats. If you're using a different seat, the process may vary.



# ASSEMBLY INSTRUCTIONS

4

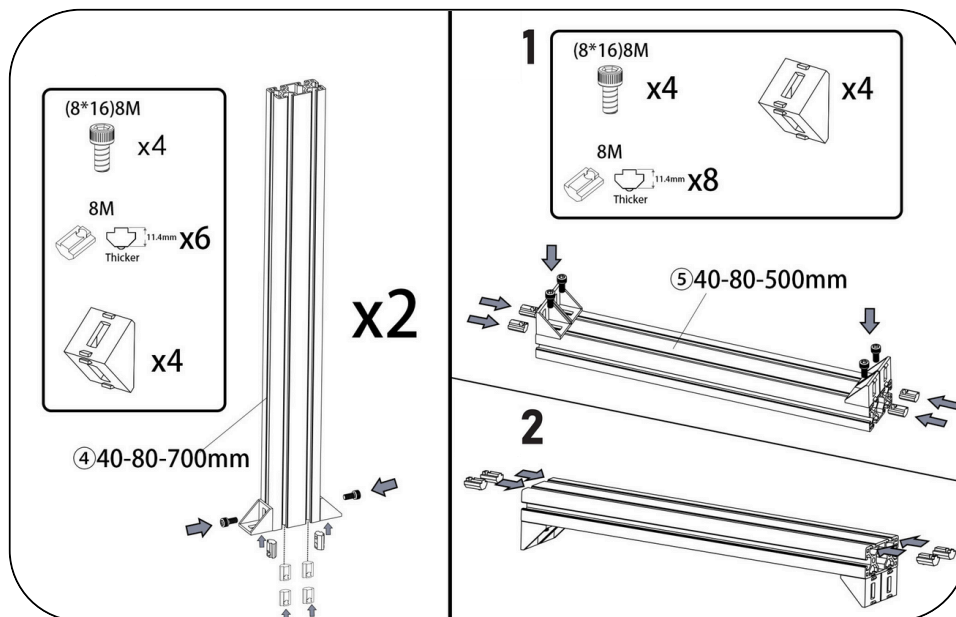

Attach corner brackets to the outside of the upright sections (Part 4), and add two sets to one side of the wheel mount section (Part 5).

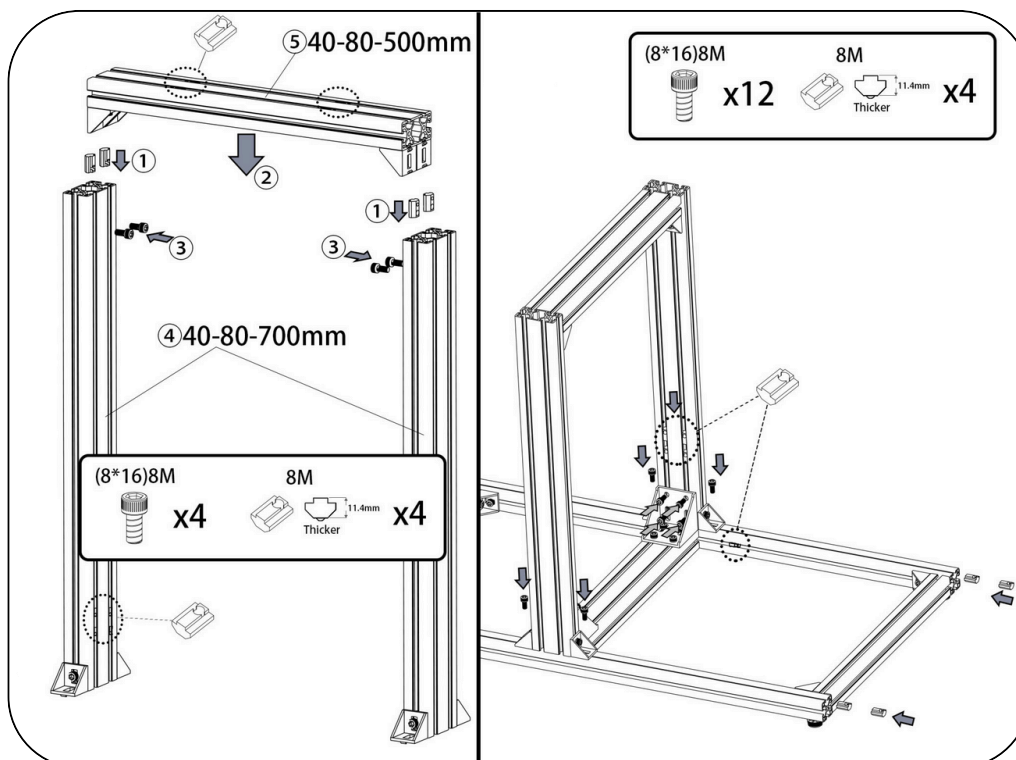

Attach the wheel mount to the upright sections using corner brackets. Then mount the entire assembly to the cockpit frame and secure it in place.

# ASSEMBLY INSTRUCTIONS

5

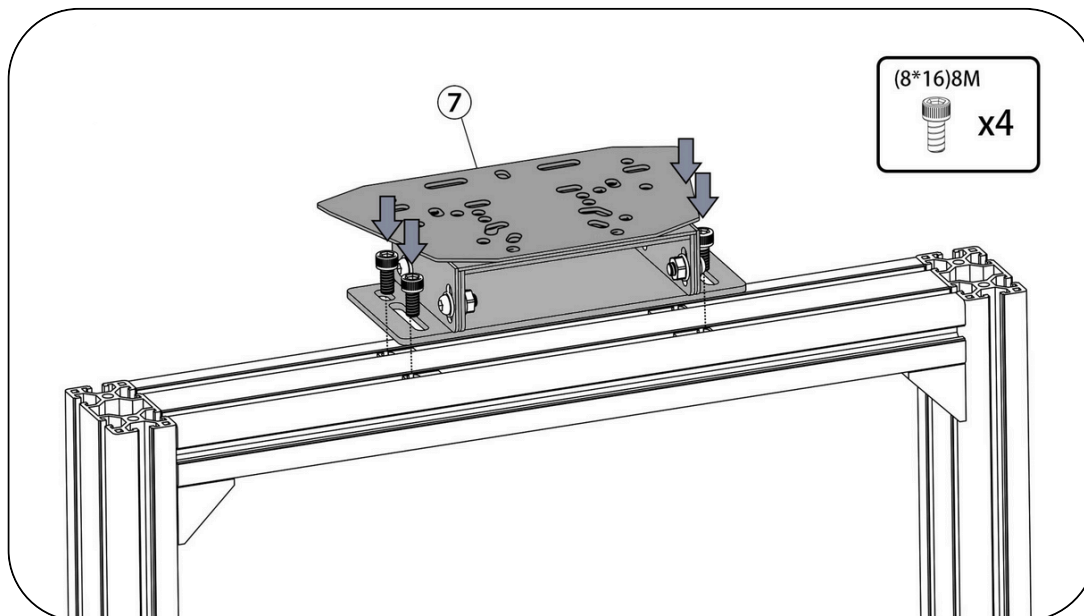

Attach the wheel deck by bolting it to the wheel mount section.  
Leave the bolts slightly loose to adjust the position before  
tightening fully.

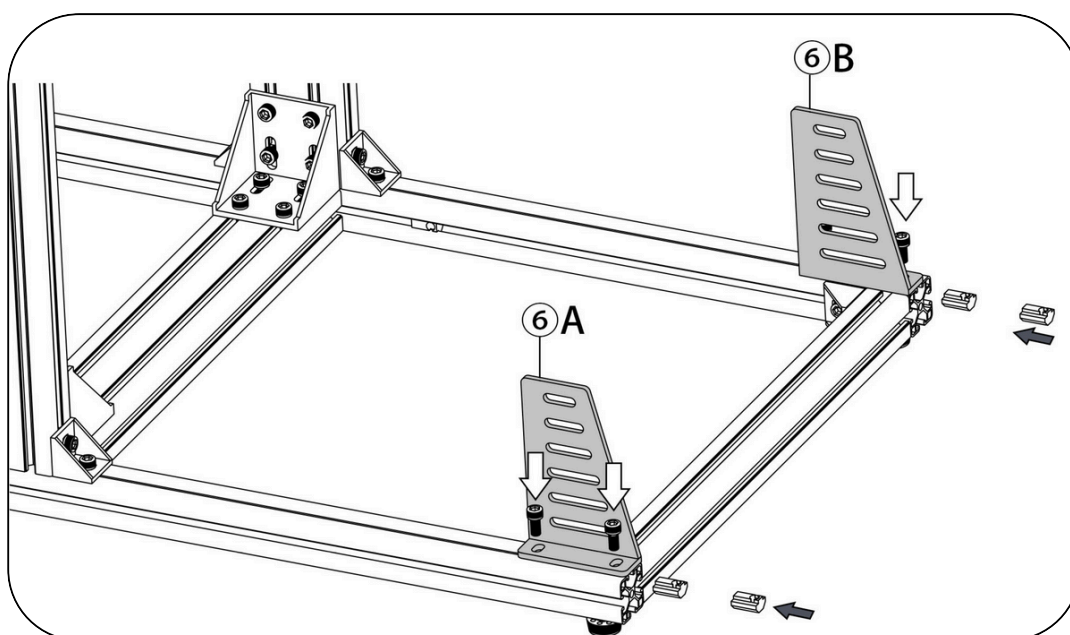

Secure the pedal tray height adjustment brackets (6A and 6B) to  
the ends of the profile using bolts and T-nuts.

# ASSEMBLY INSTRUCTIONS

6

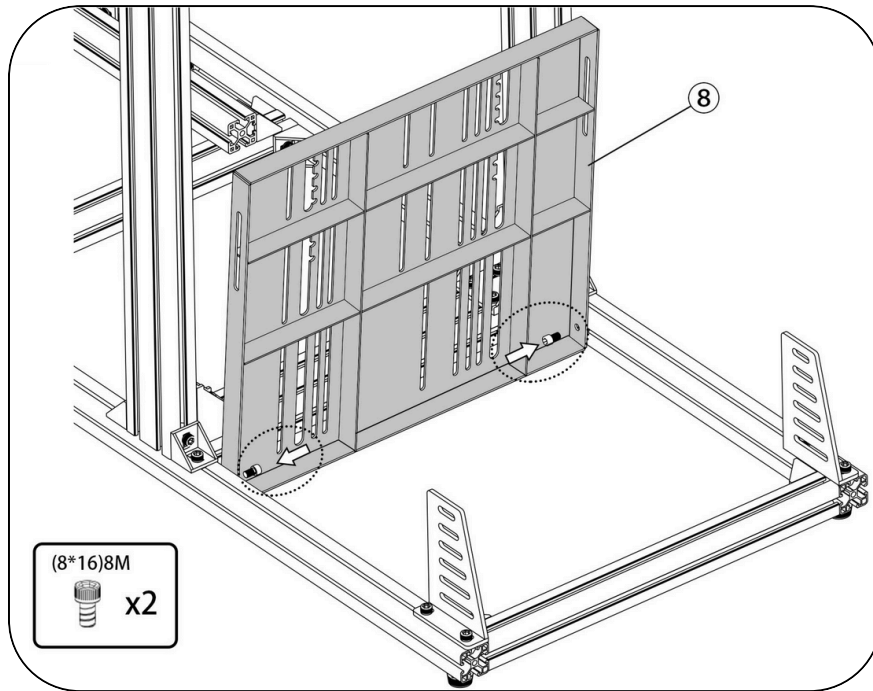

Attach the rear section of the pedal tray by bolting outward into the profile channel.

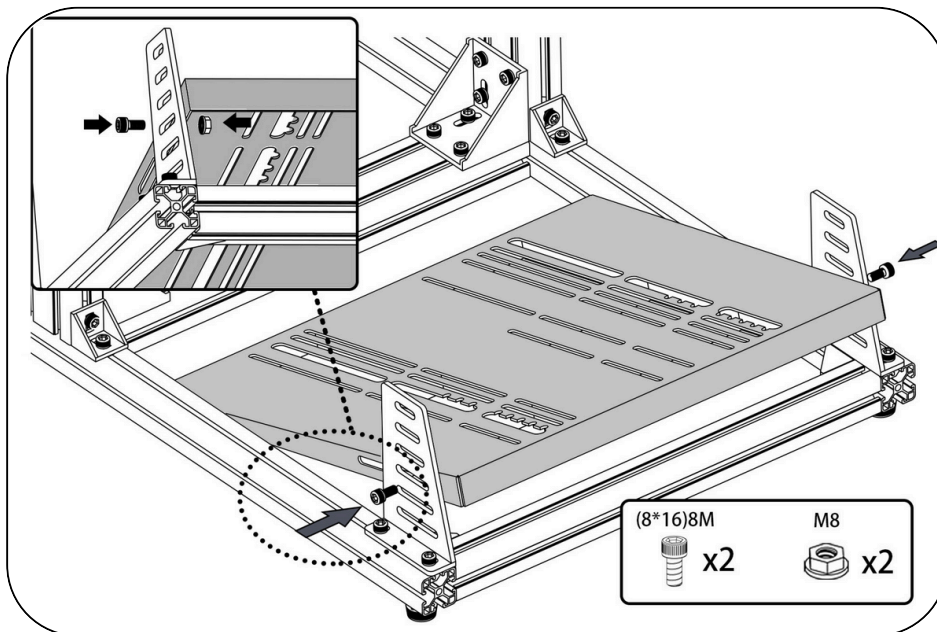

Adjust the pedal tray to your preferred distance, then set the height and angle. Once satisfied, secure everything with bolts and nuts.

# ASSEMBLY INSTRUCTIONS

7

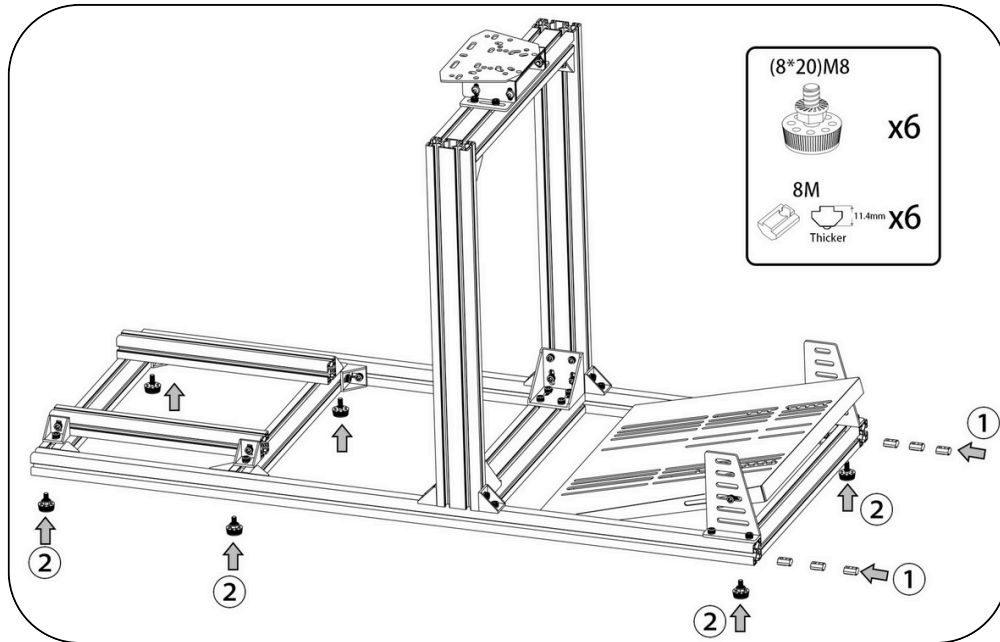

Tilt the cockpit to one side and insert T-nuts into the underside channels. Then, attach the feet and tighten them in place.

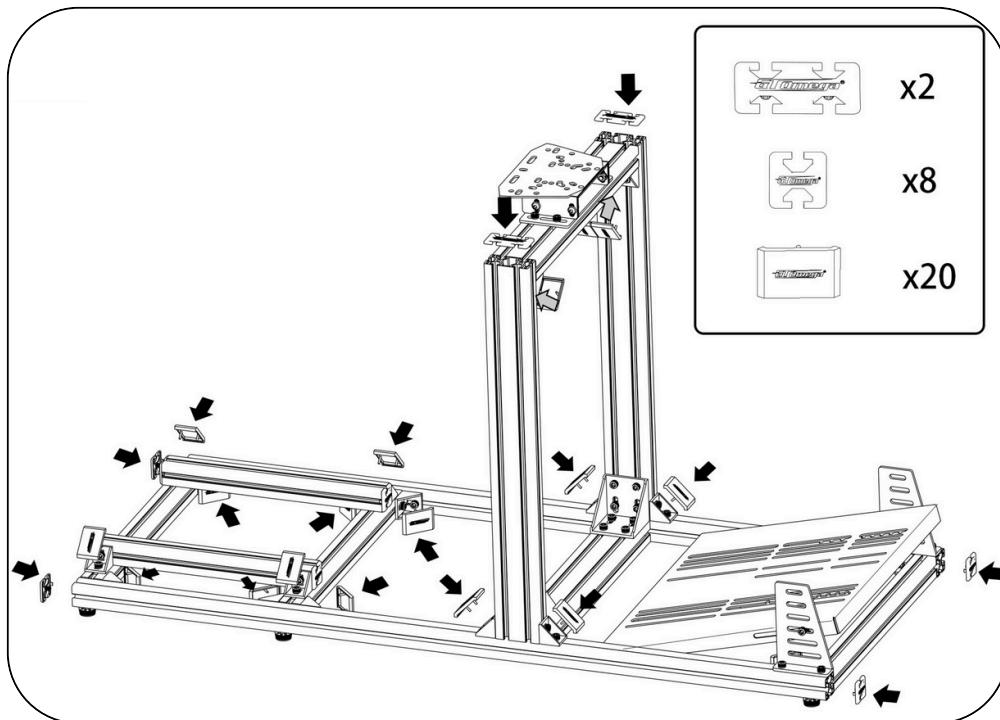

Finish your cockpit by placing plastic caps on all exposed ends of the profiles and corner brackets.

# Unlock the full potential of your

# PRIME LITER



### PRIME Keyboard Tray

This practical attachment gives you the control you need without ever having to leave your seat. The PRIME keyboard tray can be mounted at any height on the left- or right-side of your cockpit.



### PRIME Caster Wheels

Highly mobile wheels with ultra-durable construction. These heavy-duty caster wheels come in a set of 6. Height adjustable rubber feet protect your floors and help you keep your cockpit balanced.



### Simulator Floor Mat

The Simulator Floor Mat is designed to provide a slip and vibration free surface for your cockpit. The perfect finishing touch for any racing set up.



### Simulator Monitor Stand

The Simulator Monitor Stand offers stable, eye-level screen placement with no vibrations. Upgradable to triple and quadruple screen setups. Strong, adjustable, and built to last.

## Bundle and Save!

Save **up to 17%** on your sim racing accessories when you build your own accessory bundles.

[View Sim Accessory Bundles](#)